

Shaftless Screw Conveyors



KWS Shaftless Screw Conveyors efficiently convey bulk materials for many industries, including chemical, rendering, wood products and wastewater treatment.

KWS Shaftless Screw Conveyors are cost effective and provide flexibility for plant layout.

Better Performance – Zero-clearance between trough and spiral improves conveying efficiency

Higher Trough Loading – Higher conveying capacities are achieved at lower operating speeds

Lower Operation Costs – Fewer components require maintenance and replacement

Greater Flexibility – Direct transitions between equipment provide simplified plant layout

KWS high strength shaftless spirals with 350 Brinell Hardness Number (BHN) are designed for abrasive and difficult applications.

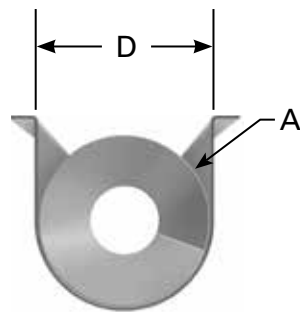
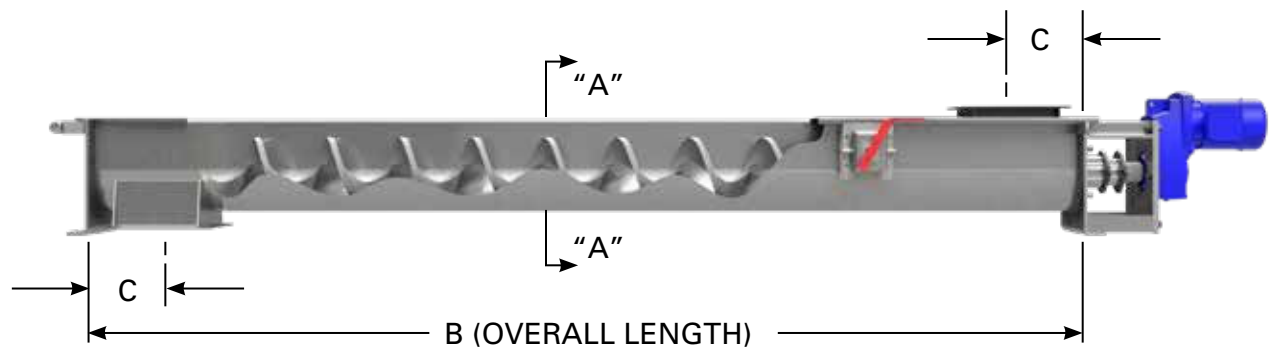

SECTION "A" – "A"

MODEL	A	B	C	D	CAPACITY
SSC900	8 1/2"	As	8"	10"	250 CFH
SSC1200	11 1/2"	Required	10 1/2"	13"	600 CFH
SSC1600	15 1/2"		13 1/2"	17"	1,400 CFH
SSC1800	17 1/2"		14 1/2"	19"	2,100 CFH
SSC2000	19 1/2"		15 1/2"	21"	3,000 CFH
SSC2400	23 1/2"		17 1/2"	25"	5,000 CFH
SSC3000	29 1/2"		20 1/2"	31"	8,000 CFH

Available Features/Options

Materials of Construction

- Spirals: High Strength Micro Alloy 350 BHN, 304/316 Stainless Steel, Nitronic, Hastelloy
- Housings: CEMA Standard U-Trough or Tubular Housing
- Liner Materials: UHMW, Xylethon and Abrasion-Resistant Steels
- Shaft Seals: Split Flanged Gland Seal with Multiple Rings of Packing
- Drive Shafts: KWS One-Piece Flanged Drive Shaft
- Spiral Hold-Downs: Over Center or Side-Angle Removable
- Covers: Flanged Covers with Bolts or Clamps and Hinges

Available Configurations

- Screw Conveyors
- Screw Feeders
- Vertical Screw Conveyors
- Live-Bottom Feeders
- Inclined Screw Conveyors
- Washers/Compactors
- Grit Washers/Classifiers

**KWS One-Piece
Drive Shaft**



**KWS Flanged
Drive Connection**



***All KWS equipment is 100-percent manufactured in the USA
by highly skilled craftsmen dedicated to producing quality products every day.***



MADE IN THE USA

KWS Manufacturing Co., Ltd.

3041 Conveyor Drive | Burleson, TX 76028

Toll-free: (800) 543-6558 | Local Phone: (817) 295-2240

Inquiries: sales@kwsmsg.com | www.kwsmsg.com

